

Situation 1:1'000

Coupe longitudinale axe pont Nord 1:1'000

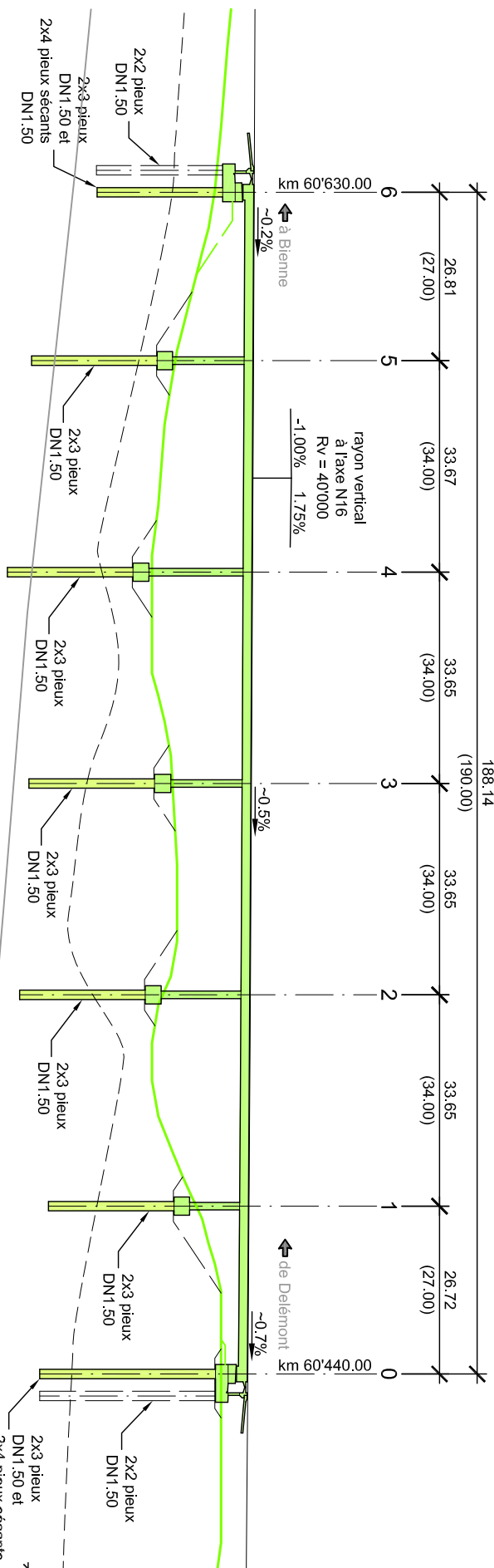

Coupe longitudinale axe pont Sud 1:1'000

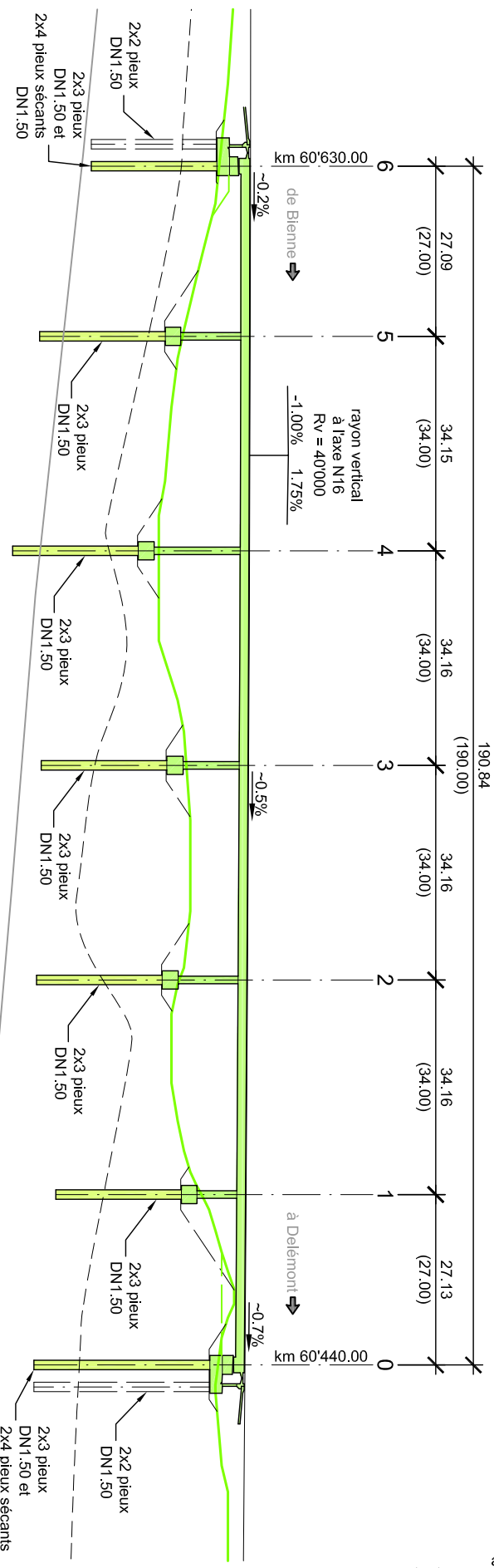

Coupe piles axe 4 1:200

Pce. 6

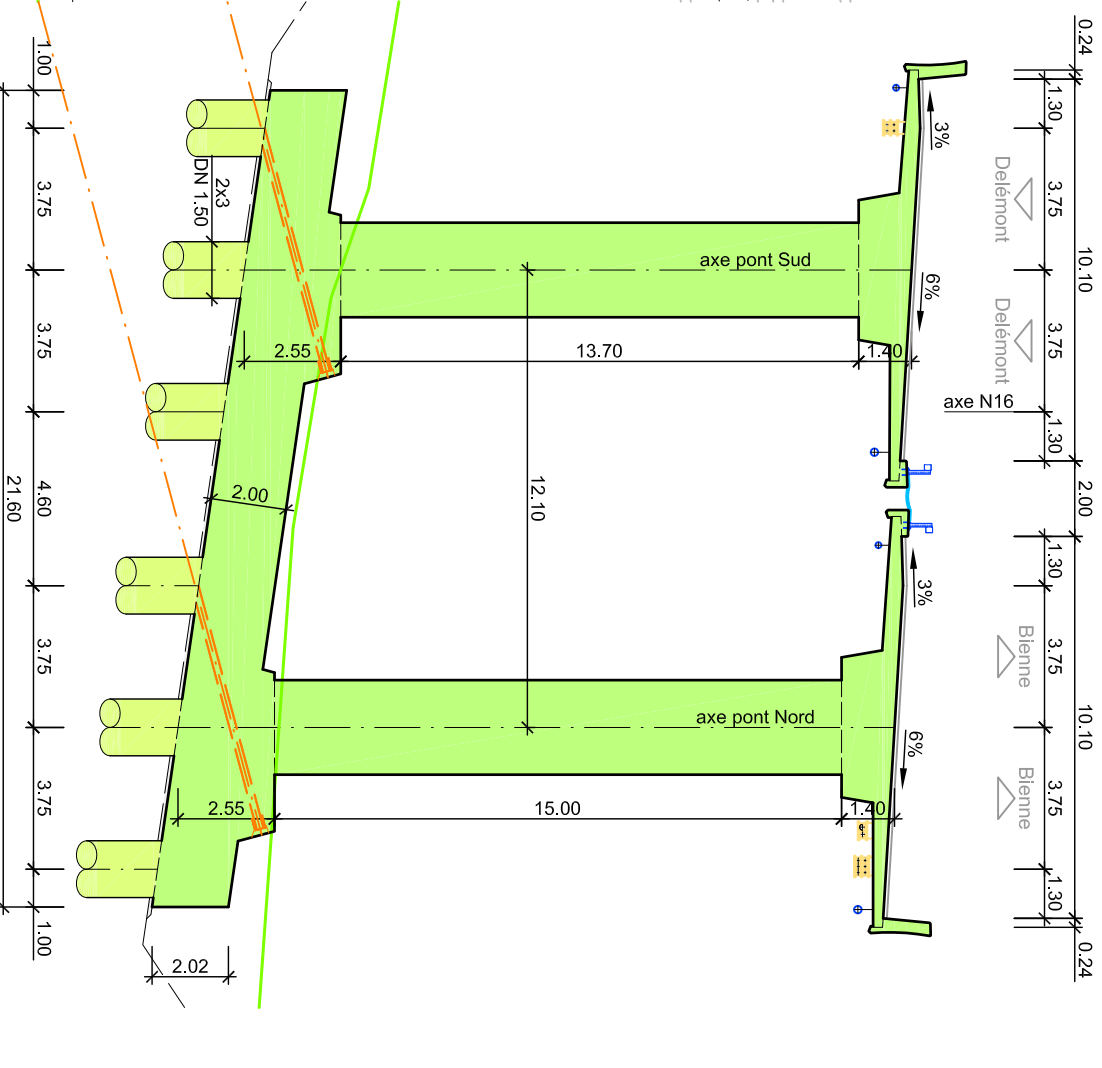

Coupe tablier 1:100

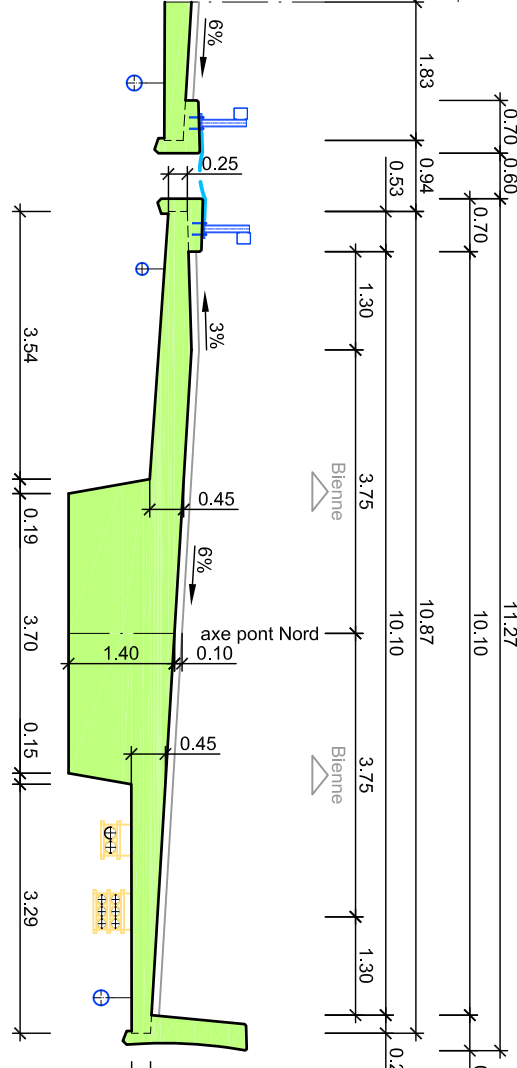

Section pile 1:100

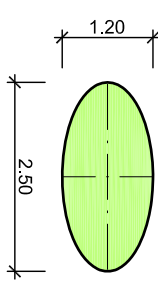

No. de l'ouvrage D 50	Nom de l'ouvrage Ponts Fin Sous Montoz	Axe N16	km 60'535	Canton BE	Commune Sorvilier	 ingénieurs civils EPF-SIA gvh tramelan sa rue de la paix 30 ch-2720 tramelan tél. 032 487 46 36 fax. 032 487 61 32 e-mail: tramelan@gvh.ch
---------------------------------	--	-------------------	---------------------	---------------------	-----------------------------	--