

N16 Court - Tavannes

TUNNEL SOUS LE MONT
Etat des travaux au 31 DECEMBRE 2009

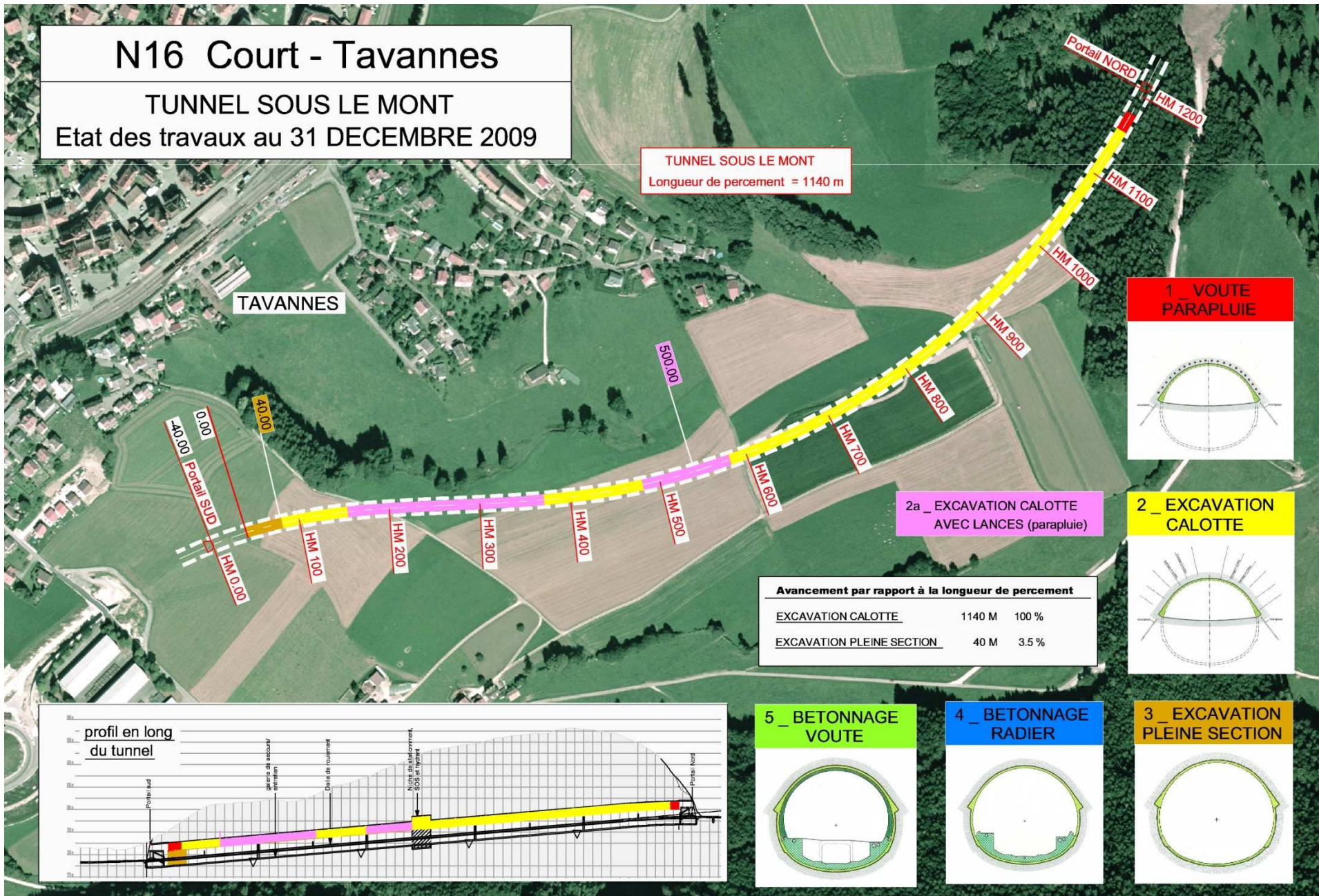

TUNNEL SOUS LE MONT
Longueur de percement = 1140 m

TAVANNES

1_ VOUTE PARAPLUIE

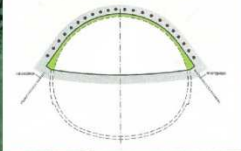

2a_ EXCAVATION CALOTTE AVEC LANCES (parapluie)

2_ EXCAVATION CALOTTE

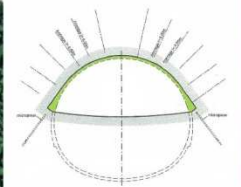

Avancement par rapport à la longueur de percement

EXCAVATION CALOTTE	1140 M	100 %
EXCAVATION PLEINE SECTION	40 M	3.5 %

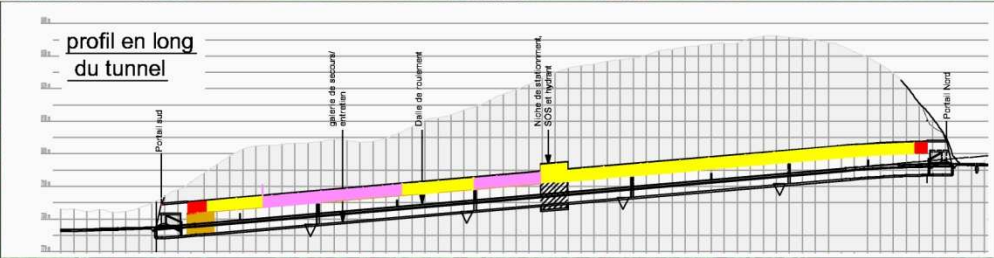

5_ BETONNAGE VOUTE

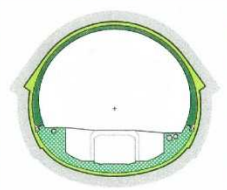

4_ BETONNAGE RADIER

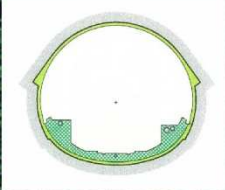

3_ EXCAVATION PLEINE SECTION

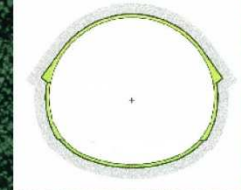

\\led\global\Affaires\9270\Intérim DGT (suivi des projets)\Tunnel Sous le Mont\Avancement travaux\SIT_ETAPE_1_EXCAVATION_ETAT_AVANCEMENT.dwg